

C 181-205

Pages 164-5

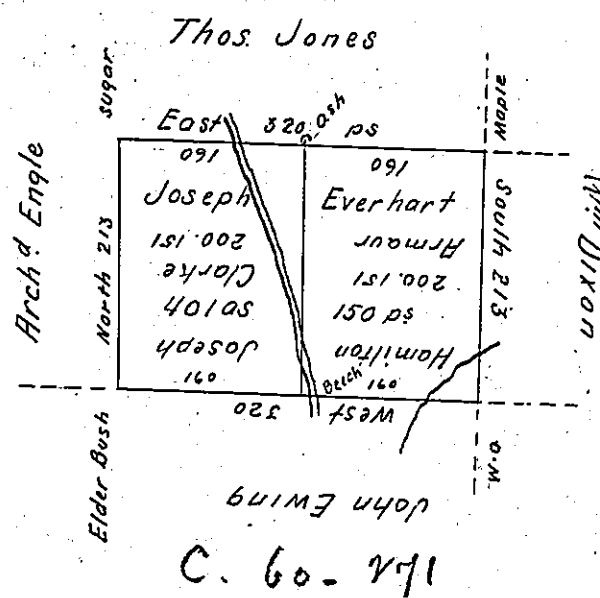

Situate on the west side of French Creek in Allegheny County Containing 401 acres 150
 ps-allowance of Six percent for Roads &c. Resurveyed the 12th July 1799. In pursuance
 of a warrant of 400 acres granted to John Everhart bearing date the 30th May 1792.
 It being the same tract of land which was Surveyed the 6th November 1794 for
 Peter Jones on his improvement dated 5th November 1794.

Crawford County S.S.

I do certify that the above is a true copy of a Survey as it stands
 Now in Followfield township Crawford County
 stated on record remaining in my office. Except the marked line of division which
 was Surveyed & marked between Joseph Clarke and Hamilton Armaur the
 4th day of July 1817.

To Rich^d T. Leech Esq^r
 Surveyor general

James Herrington D.P. Sr

IN TESTIMONY that the above is a copy of the original remaining on file in
 the Department of Internal Affairs of Pennsylvania, made
 conformably to an Act of Assembly approved the 16th day of
 February, 1833, I have hereunto set my Hand and caused
 the Seal of said Department to be affixed at Harrisburg;
 this ninth day of September 1904.

Loac B. Parsons
 Secretary of Internal Affairs.